

# DZQ 35/6 B Ex t



## Short description

Axial wall-mounted fan with square wall plate, DN350, three-phase AC, explosion-proof, medium: dust

Article number 0083.0207

## Technical data

Model	Square wall plate
Air flow volume	1.750 m <sup>3</sup> /h
Rotating speed	970 1/min
Speed controllable	✓
Reversing capacity	✓
Type of voltage	Three-phase AC
Rated voltage	400 V
Frequency	50 Hz
Nominal output	35 W
cosφ	0,38
I <sub>nom</sub>	0,13 A
I <sub>max</sub> at U <sub>Nominal</sub>	0,15 A
Degree of protection	IP 64
Insulation class	F
Type of installation	Surface-mounted
Material	Sheet steel, galvanised
Colour	galvanised
Weight	13,3 kg
Weight including packaging	15,28 kg
Nominal size	350 mm
Width	525 mm
Height	525 mm
Depth	273,5 mm
Width with packaging	540 mm
Height with packaging	540 mm
Depth with packaging	335 mm
EX designation in accordance with the ATEX Directive	Ex II 2 D
EX designation in accordance with standard	Ex tb IIIC T135°C Db IP64 X / Ex h IIIC T135°C Db X
Ta ambient temperature	-40 °C ≤ Ta ≤ +40 °C

# DZQ 35/6 B Ex t

I <sub>A</sub> /I <sub>N</sub>	3,2
Time t <sub>A</sub>	1390 sek
Operating mode	S1
PTC DIN 44082	M 80
EC type examination certificate	TÜV-A 19 ATEX0102 X, IECEx EPS 19.0018X
Temperature class	T135°C
Temperature class of insulating materials Th. Cl.	155 (F)
Packing unit	1 piece
Range	G
GTIN (EAN)	4012799832072

## Sound power level in octave range

	63 Hz	125 Hz	250 Hz	500 Hz	1 kHz	2 kHz	4 kHz	8 kHz	Total
L <sub>WA7, high</sub> (dB(A))	-	-	-	-	-	-	-	-	64

L<sub>WA7</sub>= housing and free inlet sound power level in dB.

## Characteristic curve

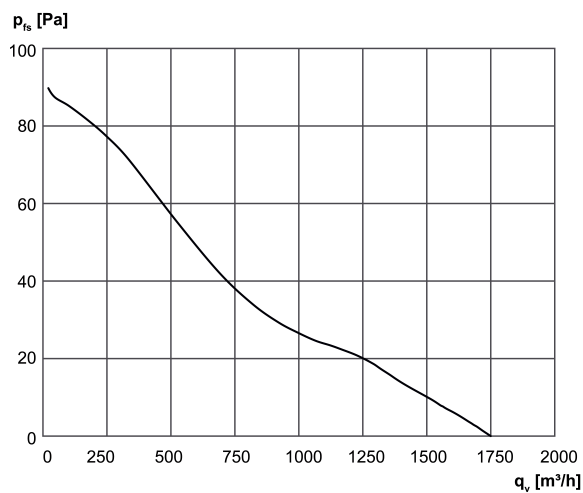

# DZQ 35/6 B Ex t

Dimensioned drawing [mm]

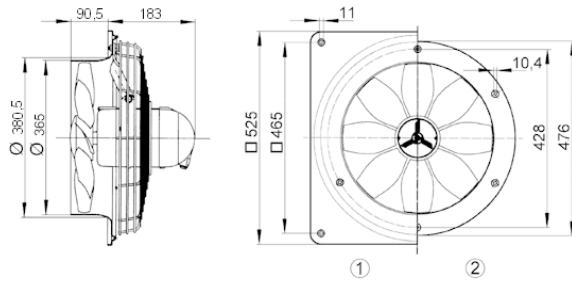

① Steel wall plate = EZQ/DZQ version

② Steel wall ring = EZS/DZS version

The air flow direction is marked.

Standard exhaust air mode, air flow direction with air drawn across motor.