

DZQ 40/4 B

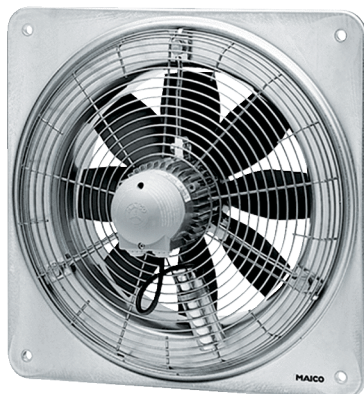

Short description

Axial wall fan with square wall plate, DN 400, three-phase AC

Application examples

Production facility, Commercial premises, Garage, Building container, Storage facility

Article number 0083.0127

Technical data

Model	Square wall plate
Air flow volume	4.260 m ³ /h
Air volume _{nom}	3.080 m ³ /h (in opt. efficiency)
Pressure p _{fs, nom}	85 Pa (in opt. efficiency)
Rotating speed n _{nom}	1.375 1/min (in opt. efficiency)
Rotating speed	1.415 1/min
Impeller type	axial
Speed controllable	✓
Reversing capacity	✓
Type of voltage	Three-phase AC
Rated voltage	400 V
Frequency	50 Hz
Nominal output	240 W (in opt. efficiency)
I _{nom}	0,6 A (in opt. efficiency)
I _{max}	0,7 A
Degree of protection	IP 55
Insulation class	B
Pole-changeable	–
Mains cable	7 x 1,5 mm ²
Installation site	Wall / Ceiling
Type of installation	Surface-mounted
Installation position	horizontal / vertical
Material	Sheet steel, galvanised
Colour	Silver
Weight	11,13 kg
Weight including packaging	13,63 kg
Nominal size	400 mm
Width	580 mm
Height	580 mm

DZQ 40/4 B

Depth	266 mm
Width with packaging	610 mm
Height with packaging	610 mm
Depth with packaging	400 mm
Airstream temperature at nominal current	60 °C
Airstream temperature at I_{Max}	-20 °C up to 60 °C
Packing unit	1 piece
Range	C
GTIN (EAN)	4012799831273

Technical data according to ErP in Best Efficiency Point (BEP)

Total efficiency η	30,3 %
Measurement category	A
Efficiency category	static
Efficiency level N	40,5
VSD necessary	No
Year of manufacture	see rating plate
Manufacturer's name / official registration number / manufacturer's place of establishment	Maico Elektroapparate-Fabrik GmbH / Freiburg registration court, HRB 601233 / Villingen-Schwenningen
Art. No.	0083.0127
P_{BEP} / Air volume $_{BEP}$ / $P_{fs, BEP}$	0,24 kW / 3.080 m ³ /h / 85 Pa
η_{BEP}	1.375 1/min
Specific ratio	≈ 1
Information about dismantling and disposal	see mounting instructions
Information about installation, operation and repairs	see mounting instructions
Objects used to measure efficiency which are not described by the measurement category	-
Sound power level $_{L_{WA7}}$	73 dB(A)

Sound power level in octave range

	63 Hz	125 Hz	250 Hz	500 Hz	1 kHz	2 kHz	4 kHz	8 kHz	Total
$L_{WA7, S1}$ (dB(A))	-	-	-	-	-	-	-	-	57
$L_{WA7, S2}$ (dB(A))	-	-	-	-	-	-	-	-	64
$L_{WA7, S3}$ (dB(A))	-	-	-	-	-	-	-	-	68
$L_{WA7, S4}$ (dB(A))	-	-	-	-	-	-	-	-	71
$L_{WA7, S5}$ (dB(A))	31	57	60	66	68	69	65	56	73

DZQ 40/4 B

	63 Hz	125 Hz	250 Hz	500 Hz	1 kHz	2 kHz	4 kHz	8 kHz	Total
$L_{WA8, S1}$ (dB(A))	-	-	-	-	-	-	-	-	67
$L_{WA8, S2}$ (dB(A))	-	-	-	-	-	-	-	-	76
$L_{WA8, S3}$ (dB(A))	-	-	-	-	-	-	-	-	77
$L_{WA8, S4}$ (dB(A))	-	-	-	-	-	-	-	-	78
$L_{WA8, S5}$ (dB(A))	52	62	65	67	78	79	79	70	79

L_{WA7} = housing and free inlet sound power level in dB.
 L_{WA8} = housing and free outlet sound power level in dB.

Characteristic curve

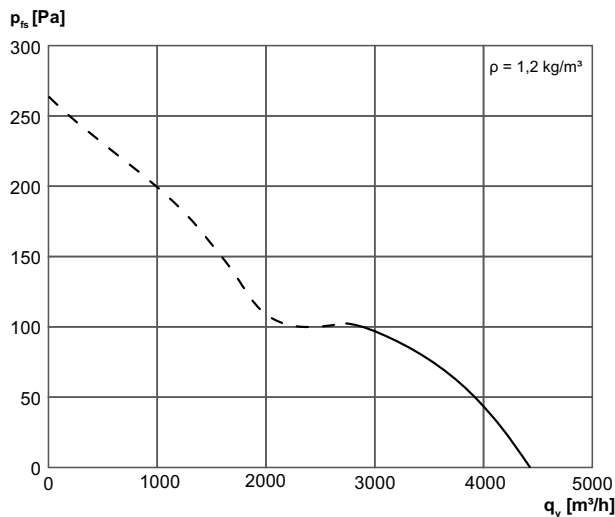

Dimensioned drawing [mm]

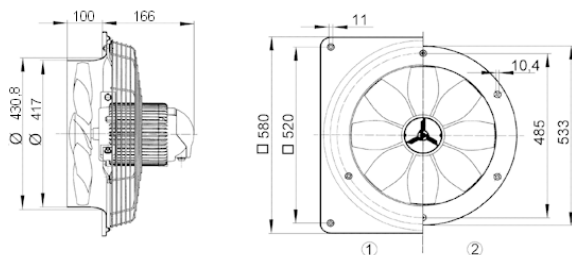

- ① Steel wall plate = EZQ/DZQ version
 - ② Steel wall ring = EZS/DZS version
- The air flow direction is marked.
 Standard exhaust air mode, air flow direction with air drawn across motor.

DZQ 40/4 B

