

DZS 30/42 B



Short description

Axial wall fan with steel wall ring, DN 300, three-phase AC, pole-changeable

Application examples

Production facility, Commercial premises, Garage, Building container, Storage facility

Article number 0094.0044

Technical data

Model	Steel wall ring
Air flow volume	1.870 m ³ /h / 3.680 m ³ /h
Air volume _{nom}	1.260 m ³ /h / 2.700 m ³ /h (in opt. efficiency)
Pressure p _{fs, nom}	53 Pa - 185 Pa (in opt. efficiency)
Rotating speed n _{nom}	1.460 1/min - 2.850 1/min (in opt. efficiency)
Rotating speed	1.467 1/min / 2.897 1/min
Impeller type	axial
Speed controllable	✓
Reversing capacity	✓
Type of voltage	Three-phase AC
Rated voltage	400 V
Frequency	50 Hz
Nominal output	70 W / 415 W (in opt. efficiency)
I _{nom}	0,3 A / 1 A (in opt. efficiency)
I _{max}	1,3 A
Degree of protection	IP 55
Insulation class	B
Pole-changeable	✓
Number of poles at high speed	2
Number of poles at low speed	4
Mains cable	5 x 1,5 mm ²
Installation site	Wall / Ceiling
Type of installation	Surface-mounted
Installation position	horizontal / vertical
Material	Sheet steel, galvanised
Colour	Silver
Weight	9,51 kg
Weight including packaging	11,19 kg
Nominal size	300 mm

DZS 30/42 B

Width	465 mm
Height	465 mm
Depth	280 mm
Width with packaging	480 mm
Height with packaging	480 mm
Depth with packaging	320 mm
Airstream temperature at nominal current	60 °C
Airstream temperature at I_{Max}	-20 °C up to 60 °C
Packing unit	1 piece
Range	C
GTIN (EAN)	4012799940449

Technical data according to ErP in Best Efficiency Point (BEP)

Total efficiency η	33,4 %
Measurement category	A
Efficiency category	static
Efficiency level N	42,4
VSD necessary	No
Year of manufacture	see rating plate
Manufacturer's name / official registration number / manufacturer's place of establishment	Maico Elektroapparate-Fabrik GmbH / Freiburg registration court, HRB 601233 / Villingen-Schwenningen
Art. No.	0094.0044
P_{BEP} / Air volume $_{BEP}$ / $P_{fs, BEP}$	0,415 kW / 2.700 m ³ /h / 185 Pa
n_{BEP}	2.850 1/min
Specific ratio	≈ 1
Information about dismantling and disposal	see mounting instructions
Information about installation, operation and repairs	see mounting instructions
Objects used to measure efficiency which are not described by the measurement category	-
Sound power level $_{L_{WA7}}$	69 dB(A) / 88 dB(A)

Sound power level in octave range

	63 Hz	125 Hz	250 Hz	500 Hz	1 kHz	2 kHz	4 kHz	8 kHz	Total
$L_{WA7, low}$ (dB(A))	29	42	62	62	63	64	60	49	69
$L_{WA7, high}$ (dB(A))	41	51	69	80	83	82	77	70	88
$L_{WA8, low}$ (dB(A))	48	52	60	62	69	70	71	68	76
$L_{WA8, high}$ (dB(A))	63	69	72	82	83	84	83	80	90

L_{WA7} = housing and free inlet sound power level in dB.

DZS 30/42 B

L_{WA8} = housing and free outlet sound power level in dB.

Characteristic curve

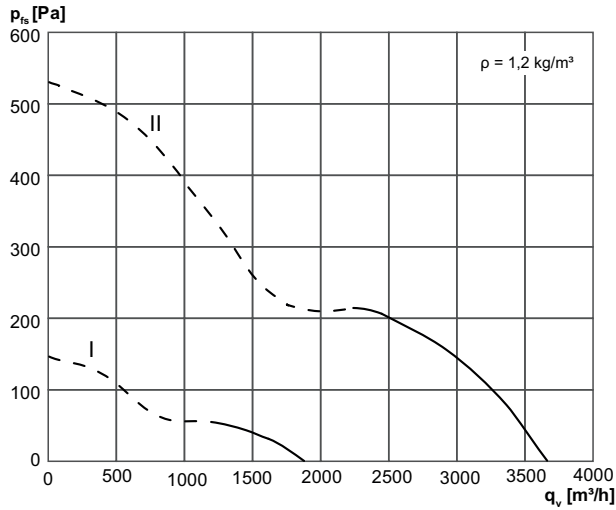

Dimensioned drawing [mm]

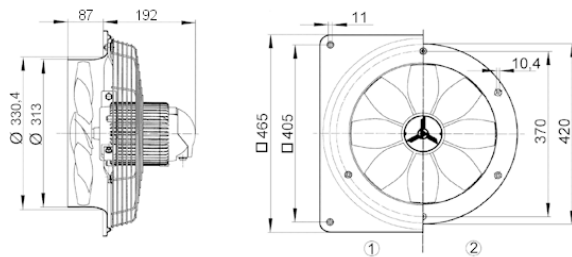

① Steel wall plate = EZQ/DZQ version

② Steel wall ring = EZS/DZS version

The air flow direction is marked.

Standard exhaust air mode, air flow direction with air drawn across motor.