

DZS 30/4 B Ex e



Short description

Axial wall-mounted fan with steel wall ring, DN300, three-phase AC, explosion-proof, medium: gas

Application examples

Environment with explosion hazard (zone 1 and 2), Dye shop, Battery room, Laboratory, Workplace

Article number 0094.0121

Technical data

Model	Steel wall ring
Air flow volume	1.730 m ³ /h
Rotating speed	1.475 1/min
Impeller type	axial
Speed controllable	✓
Reversing capacity	✓
Type of voltage	Three-phase AC
Rated voltage	400 V
Frequency	50 Hz
Nominal output	95 W
cosφ	0,28
I _{nom}	0,48 A
I _{max} at U _{Nominal}	0,49 A
Degree of protection	IP 64
Insulation class	F
Installation site	Wall / Ceiling
Type of installation	Surface-mounted
Installation position	vertical / horizontal
Material	Sheet steel, galvanised
Housing material	Sheet steel, galvanised
Colour	galvanised
Weight	7,42 kg
Weight including packaging	9,24 kg
Nominal size	300 mm
Width	465 mm
Height	465 mm
Depth	254 mm
Width with packaging	480 mm
Height with packaging	480 mm

DZS 30/4 B Ex e

Depth with packaging	320 mm
EX designation in accordance with the ATEX Directive	Ex II 2 G
EX designation in accordance with standard	Ex eb IIB + H ₂ T3 Gb / Ex h IIB + H ₂ T3 Gb
Ta ambient temperature	-40 °C ≤ Ta ≤ +60 °C
I _A /I _N	3,4
Time t _A	170 sek
Operating mode	S1
PTC DIN 44082	M 130
EC type examination certificate	TÜV-A 19 ATEX0102 X, IECEx EPS 19.0018X
Temperature class	T3
Temperature class of insulating materials Th. Cl.	155 (F)
Packing unit	1 piece
Range	G
GTIN (EAN)	4012799941217

Sound power level in octave range

	63 Hz	125 Hz	250 Hz	500 Hz	1 kHz	2 kHz	4 kHz	8 kHz	Total
L _{WA7, high} (dB(A))	-	-	-	-	-	-	-	-	69

L_{WA7}= housing and free inlet sound power level in dB.

Characteristic curve

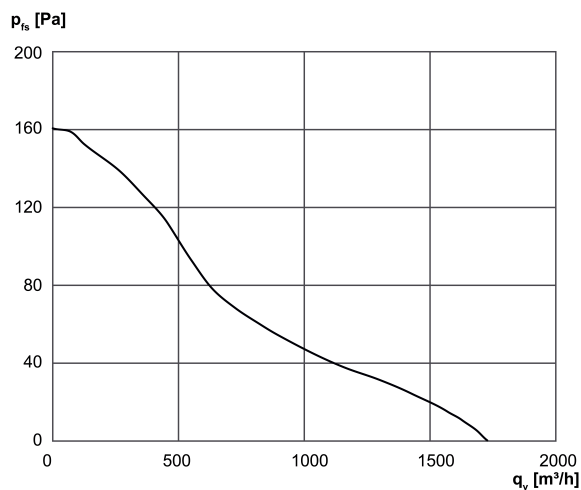

DZS 30/4 B Ex e

Dimensioned drawing [mm]

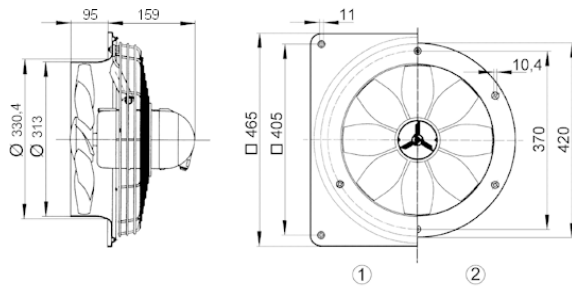

① Steel wall plate = EZQ/DZQ version

② Steel wall ring = EZS/DZS version

The air flow direction is marked.

Standard exhaust air mode, air flow direction with air drawn across motor.