

# DZS 50/6 B Ex e



## Short description

Axial wall-mounted fan with steel wall ring, DN500, three-phase AC, explosion-proof, medium: gas

## Application examples

Environment with explosion hazard (zone 1 and 2), Dye shop, Battery room, Laboratory, Workplace

Article number 0094.0128

## Technical data

Model	Steel wall ring
Air flow volume	5.320 m <sup>3</sup> /h
Rotating speed	960 1/min
Impeller type	axial
Speed controllable	✓
Reversing capacity	✓
Type of voltage	Three-phase AC
Rated voltage	400 V
Frequency	50 Hz
Nominal output	165 W
cosφ	0,41
I <sub>nom</sub>	0,56 A
I <sub>max</sub> at U <sub>Nominal</sub>	0,73 A
Degree of protection	IP 64
Insulation class	F
Installation site	Wall / Ceiling
Type of installation	Surface-mounted
Installation position	vertical / horizontal
Material	Sheet steel, galvanised
Housing material	Sheet steel, galvanised
Colour	galvanised
Weight	14,3 kg
Weight including packaging	18,53 kg
Nominal size	500 mm
Width	700 mm
Height	700 mm
Depth	270 mm
Width with packaging	720 mm
Height with packaging	720 mm

# DZS 50/6 B Ex e

Depth with packaging	420 mm
EX designation in accordance with the ATEX Directive	Ex II 2 G
EX designation in accordance with standard	Ex eb IIB + H <sub>2</sub> T4 Gb / Ex h IIB + H <sub>2</sub> T4 Gb
Ta ambient temperature	-40 °C ≤ Ta ≤ +40 °C
I <sub>A</sub> /I <sub>N</sub>	3,1
Time t <sub>A</sub>	240 sek
Operating mode	S1
PTC DIN 44082	M 100
EC type examination certificate	TÜV-A 19 ATEX0102 X, IECEx EPS 19.0018X
Temperature class	T4
Temperature class of insulating materials Th. Cl.	155 (F)
Packing unit	1 piece
Range	G
GTIN (EAN)	4012799941286

## Sound power level in octave range

	63 Hz	125 Hz	250 Hz	500 Hz	1 kHz	2 kHz	4 kHz	8 kHz	Total
L <sub>WA7, high</sub> (dB(A))	-	-	-	-	-	-	-	-	73

L<sub>WA7</sub>= housing and free inlet sound power level in dB.

## Characteristic curve

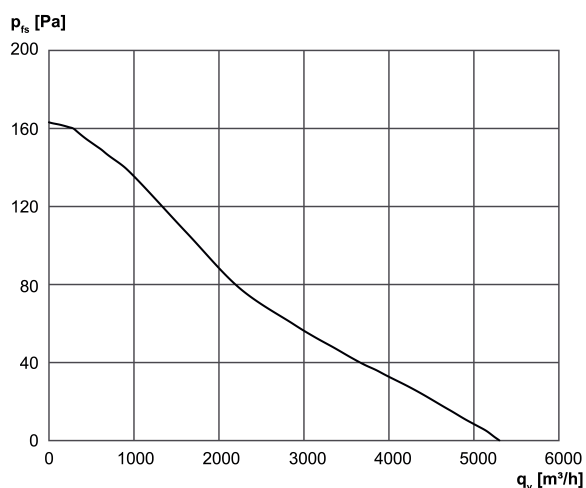

# DZS 50/6 B Ex e

Dimensioned drawing [mm]

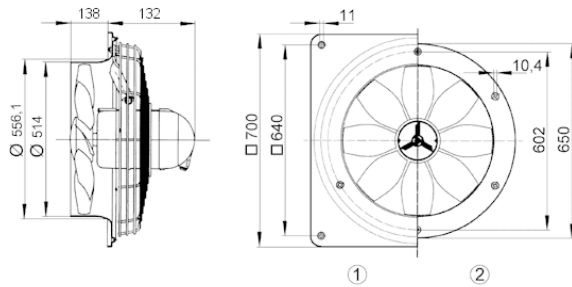

① Steel wall plate = EZQ/DZQ version

② Steel wall ring = EZS/DZS version

The air flow direction is marked.

Standard exhaust air mode, air flow direction with air drawn across motor.