

DZS 50/84 B



Short description

Axial wall fan with steel wall ring, DN 500, three-phase AC, pole-changeable

Application examples

Production facility, Commercial premises, Garage, Building container, Storage facility

Article number 0094.0054

Technical data

Model	Steel wall ring
Air flow volume	4.370 m ³ /h / 8.890 m ³ /h
Air volume _{nom}	3.040 m ³ /h / 6.600 m ³ /h (in opt. efficiency)
Pressure p _{fs, nom}	38 Pa - 145 Pa (in opt. efficiency)
Rotating speed n _{nom}	730 1/min - 1.460 1/min (in opt. efficiency)
Rotating speed	735 1/min / 1.473 1/min
Impeller type	axial
Speed controllable	✓
Reversing capacity	✓
Type of voltage	Three-phase AC
Rated voltage	400 V
Frequency	50 Hz
Nominal output	140 W / 695 W (in opt. efficiency)
I _{nom}	0,5 A / 1,4 A (in opt. efficiency)
I _{max}	2 A
Degree of protection	IP 55
Insulation class	F
Pole-changeable	✓
Number of poles at high speed	4
Number of poles at low speed	8
Mains cable	5 x 1,5 mm ²
Installation site	Wall / Ceiling
Type of installation	Surface-mounted
Installation position	horizontal / vertical
Material	Sheet steel, galvanised
Colour	Silver
Weight	27 kg
Weight including packaging	29 kg
Nominal size	500 mm

DZS 50/84 B

Width	700 mm
Height	700 mm
Depth	349 mm
Width with packaging	730 mm
Height with packaging	730 mm
Depth with packaging	430 mm
Airstream temperature at nominal current	60 °C
Airstream temperature at I_{Max}	-20 °C up to 60 °C
Packing unit	1 piece
Range	C
GTIN (EAN)	4012799940548

Technical data according to ErP in Best Efficiency Point (BEP)

Total efficiency η	38,2 %
Measurement category	A
Efficiency category	static
Efficiency level N	45,6
VSD necessary	No
Year of manufacture	see rating plate
Manufacturer's name / official registration number / manufacturer's place of establishment	Maico Elektroapparate-Fabrik GmbH / Freiburg registration court, HRB 601233 / Villingen-Schwenningen
Art. No.	0094.0054
P_{BEP} / Air volume $_{BEP}$ / $P_{fs, BEP}$	0,695 kW / 6.600 m ³ /h / 145 Pa
n_{BEP}	1.460 1/min
Specific ratio	≈ 1
Information about dismantling and disposal	see mounting instructions
Information about installation, operation and repairs	see mounting instructions
Objects used to measure efficiency which are not described by the measurement category	-
Sound power level L_{WA7}	65 dB(A) / 82 dB(A)

Sound power level in octave range

	63 Hz	125 Hz	250 Hz	500 Hz	1 kHz	2 kHz	4 kHz	8 kHz	Total
$L_{WA7, low}$ (dB(A))	30	51	53	57	61	60	53	41	65
$L_{WA7, high}$ (dB(A))	40	51	70	74	77	77	73	64	82
$L_{WA8, low}$ (dB(A))	48	55	57	60	69	69	71	68	76
$L_{WA8, high}$ (dB(A))	60	67	74	74	79	80	80	77	86

L_{WA7} = housing and free inlet sound power level in dB.

DZS 50/84 B

L_{WA8} = housing and free outlet sound power level in dB.

Characteristic curve

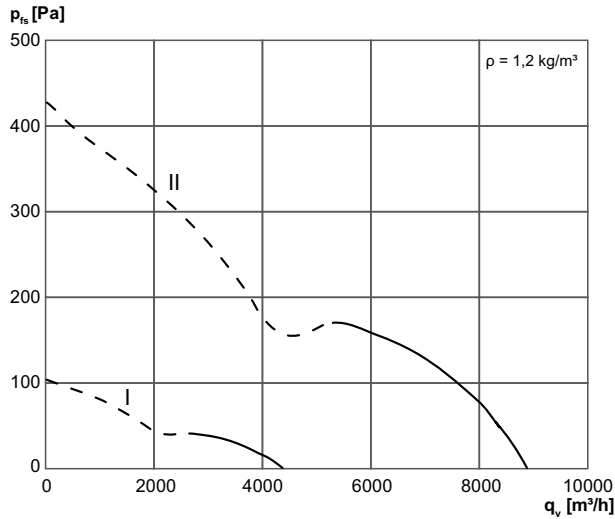

Dimensioned drawing [mm]

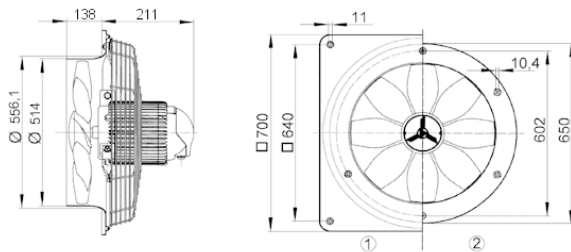

- ① Steel wall plate = EZQ/DZQ version
 - ② Steel wall ring = EZS/DZS version
- The air flow direction is marked.
Standard exhaust air mode, air flow direction with air drawn across motor.