

DZS 60/6 B



Short description

Axial wall fan with steel wall ring, DN 600, three-phase AC

Application examples

Production facility, Commercial premises, Garage, Building container, Storage facility

Article number 0094.0064

Technical data

Model	Steel wall ring
Air flow volume	9.830 m ³ /h
Air volume _{nom}	7.030 m ³ /h (in opt. efficiency)
Pressure p _{fs, nom}	90 Pa (in opt. efficiency)
Rotating speed n _{nom}	935 1/min (in opt. efficiency)
Rotating speed	979 1/min
Impeller type	axial
Speed controllable	✓
Reversing capacity	✓
Type of voltage	Three-phase AC
Rated voltage	400 V
Frequency	50 Hz
Nominal output	525 W (in opt. efficiency)
I _{nom}	1,1 A (in opt. efficiency)
I _{max}	1,4 A
Degree of protection	IP 55
Insulation class	F
Pole-changeable	–
Mains cable	7 x 1,5 mm ²
Installation site	Wall / Ceiling
Type of installation	Surface-mounted
Installation position	horizontal / vertical
Material	Sheet steel, galvanised
Colour	Silver
Weight	24 kg
Weight including packaging	28,4 kg
Nominal size	600 mm
Width	820 mm
Height	820 mm

DZS 60/6 B

Depth	340 mm
Width with packaging	850 mm
Height with packaging	850 mm
Depth with packaging	430 mm
Airstream temperature at nominal current	-20 °C up to 60 °C
Airstream temperature at I _{Max}	-20 °C up to 60 °C
Packing unit	1 piece
Range	C
GTIN (EAN)	4012799940647

Technical data according to ErP in Best Efficiency Point (BEP)

Total efficiency η	33,5 %
Measurement category	A
Efficiency category	static
Efficiency level N	41,6
VSD necessary	No
Year of manufacture	see rating plate
Manufacturer's name / official registration number / manufacturer's place of establishment	Maico Elektroapparate-Fabrik GmbH / Freiburg registration court, HRB 601233 / Villingen-Schwenningen
Art. No.	0094.0064
P _{BEP} / Air volume _{BEP} / P _{fs, BEP}	0,525 kW / 7.030 m ³ /h / 90 Pa
n_{BEP}	935 1/min
Specific ratio	≈ 1
Information about dismantling and disposal	see mounting instructions
Information about installation, operation and repairs	see mounting instructions
Objects used to measure efficiency which are not described by the measurement category	-
Sound power level _{L_{WA7}}	78 dB(A)

Sound power level in octave range

	63 Hz	125 Hz	250 Hz	500 Hz	1 kHz	2 kHz	4 kHz	8 kHz	Total
L_{WA7}, Level 5 (dB(A))	38	59	61	70	73	73	66	55	77
L_{WA8}, Level 5 (dB(A))	52	63	65	71	74	74	73	70	80

L_{WA7}= housing and free inlet sound power level in dB.

L_{WA8}= housing and free outlet sound power level in dB.

DZS 60/6 B

Characteristic curve

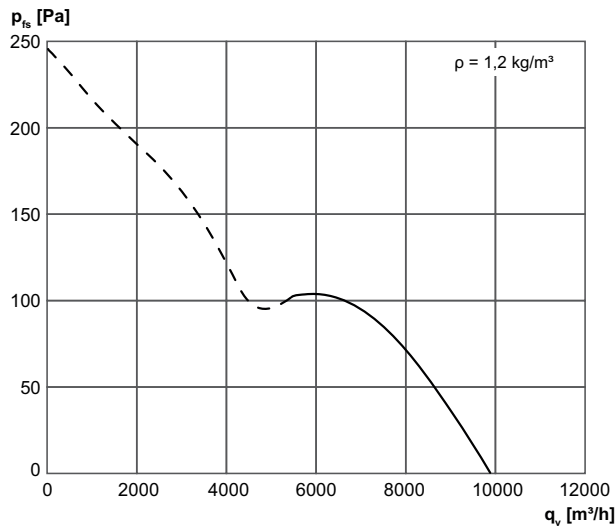

Dimensioned drawing [mm]

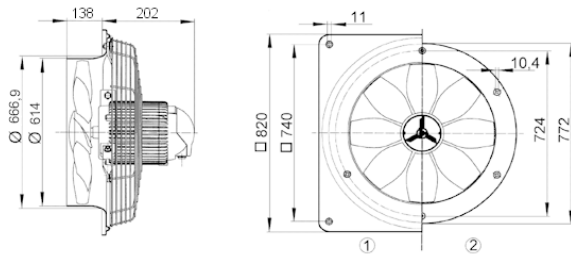

- ① Steel wall plate = EZQ/DZQ version
 - ② Steel wall ring = EZS/DZS version
- The air flow direction is marked.
Standard exhaust air mode, air flow direction with air drawn across motor.