

EZQ 35/4 B

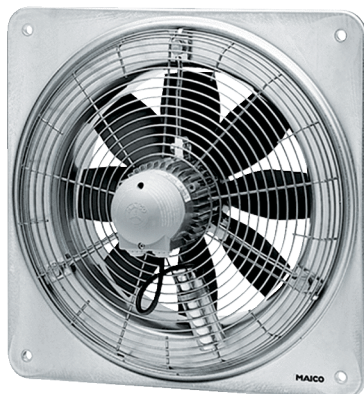

Short description

Axial wall fan with square wall plate, DN 350, single-phase AC

Application examples

Production facility, Commercial premises, Garage, Building container, Storage facility

Article number 0083.0114

Technical data

Model	Square wall plate
Air flow volume	2.810 m ³ /h
Air volume _{nom}	1.870 m ³ /h (in opt. efficiency)
Pressure p _{fs, nom}	70 Pa (in opt. efficiency)
Rotating speed n _{nom}	1.390 1/min (in opt. efficiency)
Rotating speed	1.427 1/min
Impeller type	axial
Speed controllable	✓
Reversing capacity	✓
Type of voltage	Alternating current
Rated voltage	230 V
Frequency	50 Hz
Nominal output	128 W (in opt. efficiency)
I _{nom}	0,55 A (in opt. efficiency)
I _{max}	0,8 A
Degree of protection	IP 55
Insulation class	B
Pole-changeable	–
Installation site	Wall / Ceiling
Type of installation	Surface-mounted
Installation position	horizontal / vertical
Material	Sheet steel, galvanised
Colour	Silver
Weight	9,2 kg
Weight including packaging	11 kg
Nominal size	350 mm
Width	525 mm
Height	525 mm
Depth	244 mm

EZQ 35/4 B

Width with packaging	540 mm
Height with packaging	540 mm
Depth with packaging	335 mm
Airstream temperature at nominal current	70 °C
Airstream temperature at I_{Max}	-20 °C up to 60 °C
Packing unit	1 piece
Range	C
GTIN (EAN)	4012799831143

Technical data according to ErP in Best Efficiency Point (BEP)

Total efficiency η	28,4 %
Measurement category	A
Efficiency category	static
Efficiency level N	40,4
VSD necessary	No
Year of manufacture	see rating plate
Manufacturer's name / official registration number / manufacturer's place of establishment	Maico Elektroapparate-Fabrik GmbH / Freiburg registration court, HRB 601233 / Villingen-Schwenningen
Art. No.	0083.0114
P_{BEP} / Air volume $_{BEP}$ / $P_{fs, BEP}$	0,128 kW / 1.870 m ³ /h / 70 Pa
n_{BEP}	1.390 1/min
Specific ratio	≈ 1
Information about dismantling and disposal	see mounting instructions
Information about installation, operation and repairs	see mounting instructions
Objects used to measure efficiency which are not described by the measurement category	-
Sound power level $_{L_{WA7}}$	70 dB(A)

Sound power level in octave range

	63 Hz	125 Hz	250 Hz	500 Hz	1 kHz	2 kHz	4 kHz	8 kHz	Total
$L_{WA7, S1}$ (dB(A))	28	32	34	39	41	38	28	19	45
$L_{WA7, S2}$ (dB(A))	25	44	44	50	53	54	46	33	58
$L_{WA7, S3}$ (dB(A))	30	52	52	57	61	63	57	46	66
$L_{WA7, S4}$ (dB(A))	31	50	59	61	63	65	60	49	69
$L_{WA7, S5}$ (dB(A))	31	54	60	62	64	66	61	50	70
$L_{WA8, S1}$ (dB(A))	29	34	34	39	41	37	26	6	45

EZQ 35/4 B

	63 Hz	125 Hz	250 Hz	500 Hz	1 kHz	2 kHz	4 kHz	8 kHz	Total
L_{WA8, S2} (dB(A))	31	47	45	50	61	61	63	61	68
L_{WA8, S3} (dB(A))	48	55	58	61	69	70	72	69	76
L_{WA8, S4} (dB(A))	50	57	62	63	70	71	72	70	77
L_{WA8, S5} (dB(A))	51	58	62	64	70	71	72	69	77

L_{WA7}= housing and free inlet sound power level in dB.
 L_{WA8}= housing and free outlet sound power level in dB.

Characteristic curve

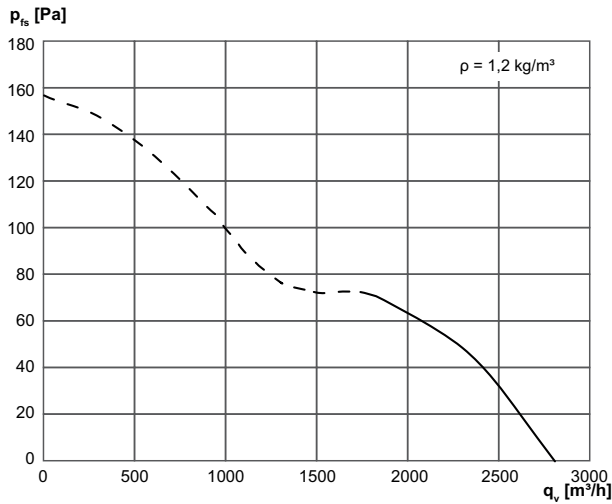

Dimensioned drawing [mm]

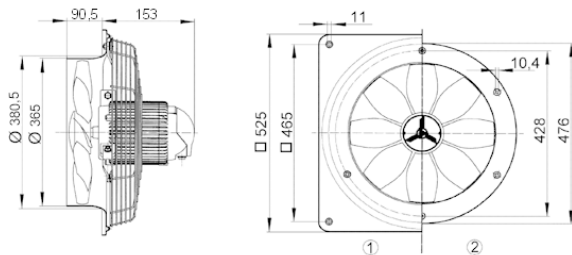

- ① Steel wall plate = EZQ/DZQ version
 - ② Steel wall ring = EZS/DZS version
- The air flow direction is marked.
 Standard exhaust air mode, air flow direction with air drawn across motor.