

# EZQ 50/8 B

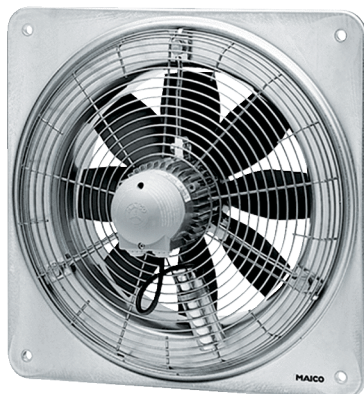

## Short description

Axial wall fan with square wall plate, DN 500, single-phase AC

## Application examples

Production facility, Commercial premises, Garage, Building container, Storage facility

Article number 0083.0112

## Technical data

Model	Square wall plate
Air flow volume	4.200 m <sup>3</sup> /h
Rotating speed	715 1/min
Impeller type	axial
Speed controllable	✓
Reversing capacity	✓
Type of voltage	Alternating current
Rated voltage	230 V
Frequency	50 Hz
Nominal output	110 W
I <sub>nom</sub>	0,55 A
I <sub>max</sub>	0,6 A
Degree of protection	IP 55
Insulation class	B
Pole-changeable	-
Installation site	Wall / Ceiling
Type of installation	Surface-mounted
Installation position	horizontal / vertical
Material	Sheet steel, galvanised
Colour	Silver
Weight	17,56 kg
Weight including packaging	21,46 kg
Nominal size	500 mm
Width	700 mm
Height	700 mm
Depth	329 mm
Width with packaging	730 mm
Height with packaging	730 mm
Depth with packaging	400 mm

# EZQ 50/8 B

Airstream temperature at nominal current	-20 °C up to 60 °C
Airstream temperature at I <sub>Max</sub>	-20 °C up to 60 °C
Packing unit	1 piece
Range	C
GTIN (EAN)	4012799831129

## Sound power level in octave range

	63 Hz	125 Hz	250 Hz	500 Hz	1 kHz	2 kHz	4 kHz	8 kHz	Total
<b>L<sub>WA7, S1</sub></b> <b>(dB(A))</b>	13	27	28	34	30	21	11	10	37
<b>L<sub>WA7, S2</sub></b> <b>(dB(A))</b>	25	34	36	40	44	39	27	15	47
<b>L<sub>WA7, S3</sub></b> <b>(dB(A))</b>	37	40	45	50	56	54	45	33	59
<b>L<sub>WA7, S4</sub></b> <b>(dB(A))</b>	34	48	50	55	60	59	51	40	64
<b>L<sub>WA7, S5</sub></b> <b>(dB(A))</b>	31	54	51	56	61	60	53	42	65
<b>L<sub>WA8, S1</sub></b> <b>(dB(A))</b>	15	26	28	42	30	21	12	10	43
<b>L<sub>WA8, S2</sub></b> <b>(dB(A))</b>	29	33	36	40	42	38	27	16	46
<b>L<sub>WA8, S3</sub></b> <b>(dB(A))</b>	42	43	49	53	64	65	67	64	71
<b>L<sub>WA8, S4</sub></b> <b>(dB(A))</b>	44	52	54	57	67	68	69	67	74
<b>L<sub>WA8, S5</sub></b> <b>(dB(A))</b>	45	54	54	58	67	68	69	67	74

L<sub>WA7</sub>= housing and free inlet sound power level in dB.

L<sub>WA8</sub>= housing and free outlet sound power level in dB.

# EZQ 50/8 B

## Characteristic curve

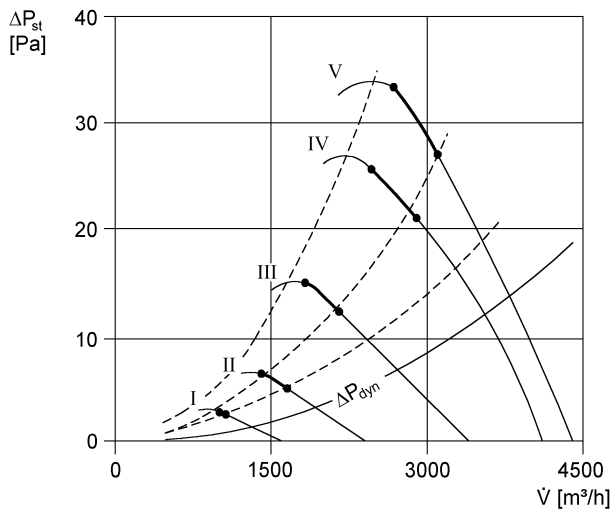

## Dimensioned drawing [mm]

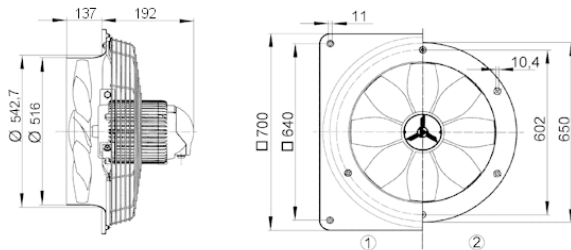

- ① Steel wall plate = EZQ/DZQ version
  - ② Steel wall ring = EZS/DZS version
- The air flow direction is marked.  
Standard exhaust air mode, air flow direction with air drawn across motor.