

EZS 30/2 B



Short description

Axial wall fan with steel wall ring, DN 300, single-phase AC

Application examples

Production facility, Commercial premises, Garage, Building container, Storage facility

Article number 0094.0004

Technical data

Model	Steel wall ring
Air flow volume	3.600 m ³ /h
Air volume _{nom}	2.700 m ³ /h (in opt. efficiency)
Pressure p _{fs, nom}	170 Pa (in opt. efficiency)
Rotating speed n _{nom}	2.840 1/min (in opt. efficiency)
Rotating speed	2.881 1/min
Impeller type	axial
Speed controllable	✓
Reversing capacity	✓
Type of voltage	Alternating current
Rated voltage	230 V
Frequency	50 Hz
Nominal output	350 W (in opt. efficiency)
I _{nom}	1,6 A (in opt. efficiency)
I _{max}	2,7 A
Degree of protection	IP 55
Insulation class	B
Pole-changeable	–
Installation site	Wall / Ceiling
Type of installation	Surface-mounted
Installation position	horizontal / vertical
Material	Sheet steel, galvanised
Colour	Silver
Weight	9,77 kg
Weight including packaging	11,45 kg
Nominal size	300 mm
Width	465 mm
Height	465 mm
Depth	279 mm

EZS 30/2 B

Width with packaging	480 mm
Height with packaging	480 mm
Depth with packaging	320 mm
Airstream temperature at nominal current	-20 °C up to 80 °C
Airstream temperature at I _{Max}	-20 °C up to 40 °C
Packing unit	1 piece
Range	C
GTIN (EAN)	4012799940043

Technical data according to ErP in Best Efficiency Point (BEP)

Total efficiency η	36,4 %
Measurement category	A
Efficiency category	static
Efficiency level N	45,6
VSD necessary	No
Year of manufacture	see rating plate
Manufacturer's name / official registration number / manufacturer's place of establishment	Maico Elektroapparate-Fabrik GmbH / Freiburg registration court, HRB 601233 / Villingen-Schwenningen
Art. No.	0094.0004
P _{BEP} / Air volume _{BEP} / P _{fs, BEP}	0,35 kW / 2.700 m ³ /h / 170 Pa
n _{BEP}	2.840 1/min
Specific ratio	≈ 1
Information about dismantling and disposal	see mounting instructions
Information about installation, operation and repairs	see mounting instructions
Objects used to measure efficiency which are not described by the measurement category	-
Sound power level L _{WA7}	88 dB(A)

Sound power level in octave range

	63 Hz	125 Hz	250 Hz	500 Hz	1 kHz	2 kHz	4 kHz	8 kHz	Total
L _{WA7, S1} (dB(A))	27	47	51	54	57	58	53	40	63
L _{WA7, S2} (dB(A))	34	55	67	68	71	73	69	60	77
L _{WA7, S3} (dB(A))	39	59	72	77	78	80	76	68	84
L _{WA7, S4} (dB(A))	43	58	69	81	81	81	77	69	87
L _{WA7, S5} (dB(A))	44	53	67	82	82	82	78	70	88
L _{WA8, S1} (dB(A))	33	48	49	54	65	65	67	65	72

EZS 30/2 B

	63 Hz	125 Hz	250 Hz	500 Hz	1 kHz	2 kHz	4 kHz	8 kHz	Total
L_{WA8, S2} (dB(A))	52	59	66	66	73	74	74	71	80
L_{WA8, S3} (dB(A))	59	66	74	75	80	81	81	78	87
L_{WA8, S4} (dB(A))	60	66	70	81	82	82	81	78	88
L_{WA8, S5} (dB(A))	60	66	70	82	82	83	82	78	89

L_{WA7}= housing and free inlet sound power level in dB.

L_{WA8}= housing and free outlet sound power level in dB.

Characteristic curve

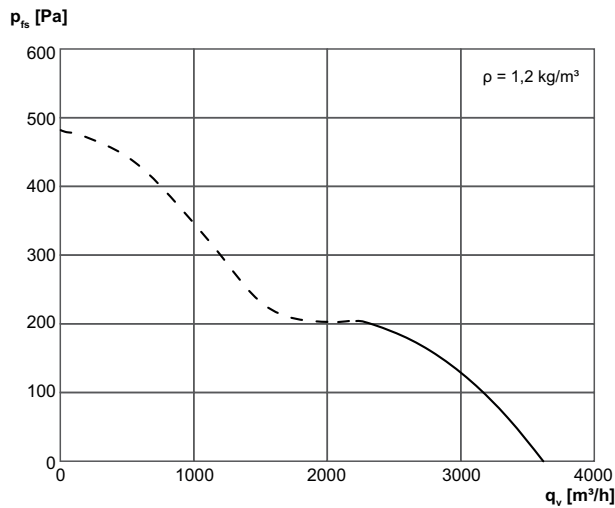

Dimensioned drawing [mm]

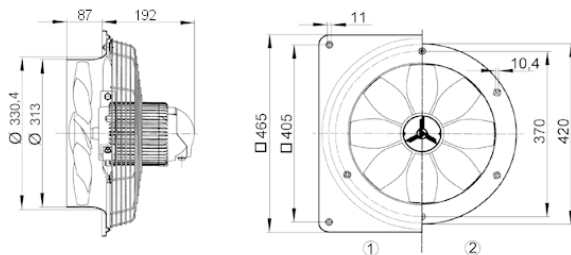

① Steel wall plate = EZQ/DZQ version

② Steel wall ring = EZS/DZS version

The air flow direction is marked.

Standard exhaust air mode, air flow direction with air drawn across motor.