

# EZS 35/4 B



## Short description

Axial wall fan with steel wall ring, DN 350, single-phase AC

## Application examples

Production facility, Commercial premises, Garage, Building container, Storage facility

Article number 0094.0007

## Technical data

Model	Steel wall ring
Air flow volume	2.810 m <sup>3</sup> /h
Air volume <sub>nom</sub>	1.870 m <sup>3</sup> /h (in opt. efficiency)
Pressure p <sub>fs, nom</sub>	70 Pa (in opt. efficiency)
Rotating speed n <sub>nom</sub>	1.390 1/min (in opt. efficiency)
Rotating speed	1.427 1/min
Impeller type	axial
Speed controllable	✓
Reversing capacity	✓
Type of voltage	Alternating current
Rated voltage	230 V
Frequency	50 Hz
Nominal output	128 W (in opt. efficiency)
I <sub>nom</sub>	0,55 A (in opt. efficiency)
I <sub>max</sub>	0,8 A
Degree of protection	IP 55
Insulation class	B
Pole-changeable	–
Installation site	Wall / Ceiling
Type of installation	Surface-mounted
Installation position	horizontal / vertical
Material	Sheet steel, galvanised
Colour	Silver
Weight	6,44 kg
Weight including packaging	9,01 kg
Nominal size	350 mm
Width	525 mm
Height	525 mm
Depth	248 mm

# EZS 35/4 B

Width with packaging	615 mm
Height with packaging	615 mm
Depth with packaging	400 mm
Airstream temperature at nominal current	70 °C
Airstream temperature at $I_{Max}$	-20 °C up to 60 °C
Packing unit	1 piece
Range	C
GTIN (EAN)	4012799940074

## Technical data according to ErP in Best Efficiency Point (BEP)

Total efficiency $\eta$	28,4 %
Measurement category	A
Efficiency category	static
Efficiency level N	40,4
VSD necessary	No
Year of manufacture	see rating plate
Manufacturer's name / official registration number / manufacturer's place of establishment	Maico Elektroapparate-Fabrik GmbH / Freiburg registration court, HRB 601233 / Villingen-Schwenningen
Art. No.	0094.0007
$P_{BEP}$ / Air volume $_{BEP}$ / $P_{fs, BEP}$	0,128 kW / 1.870 m <sup>3</sup> /h / 70 Pa
$n_{BEP}$	1.390 1/min
Specific ratio	≈ 1
Information about dismantling and disposal	see mounting instructions
Information about installation, operation and repairs	see mounting instructions
Objects used to measure efficiency which are not described by the measurement category	-
Sound power level $_{L_{WA7}}$	70 dB(A)

## Sound power level in octave range

	63 Hz	125 Hz	250 Hz	500 Hz	1 kHz	2 kHz	4 kHz	8 kHz	Total
$L_{WA7, S1}$ (dB(A))	28	32	34	39	41	38	28	19	45
$L_{WA7, S2}$ (dB(A))	25	44	44	50	53	54	46	33	58
$L_{WA7, S3}$ (dB(A))	30	52	52	57	61	63	57	46	66
$L_{WA7, S4}$ (dB(A))	31	50	59	61	63	65	60	49	69
$L_{WA7, S5}$ (dB(A))	31	54	60	62	64	66	61	50	70
$L_{WA8, S1}$ (dB(A))	29	34	34	39	41	37	26	6	45

# EZS 35/4 B

	63 Hz	125 Hz	250 Hz	500 Hz	1 kHz	2 kHz	4 kHz	8 kHz	Total
<b>L<sub>WA8, S2</sub></b> <b>(dB(A))</b>	31	47	45	50	61	61	63	61	68
<b>L<sub>WA8, S3</sub></b> <b>(dB(A))</b>	48	55	58	61	69	70	72	69	76
<b>L<sub>WA8, S4</sub></b> <b>(dB(A))</b>	50	57	62	63	70	71	72	70	77
<b>L<sub>WA8, S5</sub></b> <b>(dB(A))</b>	51	58	62	64	70	71	72	69	77

L<sub>WA7</sub>= housing and free inlet sound power level in dB.

L<sub>WA8</sub>= housing and free outlet sound power level in dB.

## Characteristic curve

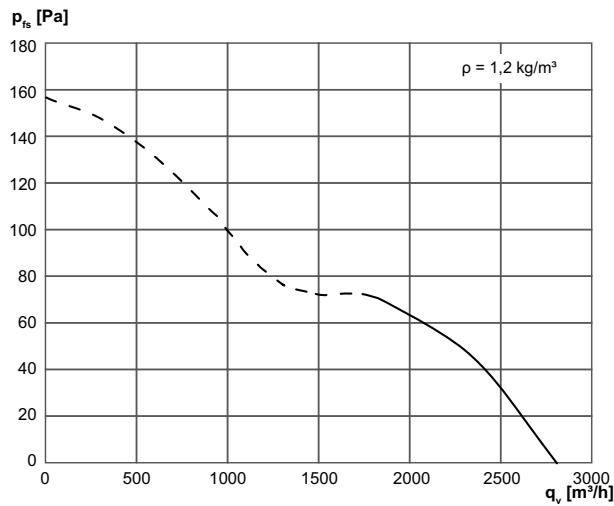

## Dimensioned drawing [mm]

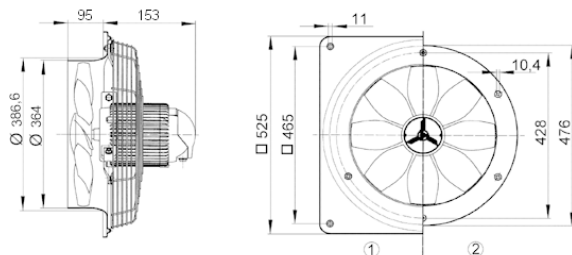

① Steel wall plate = EZQ/DZQ version

② Steel wall ring = EZS/DZS version

The air flow direction is marked.

Standard exhaust air mode, air flow direction with air drawn across motor.