

geniovent.x 900 H D-G-SU



Short description

Decentralised RLT air handling unit with very good heat recovery. With cross-counterflow heat exchanger and pre-heating register, upwards outside and outgoing air connections, outlet at the bottom, fully covered. CO2 sensor integrated in unit. With app for mobile unit control system

Application examples

Classroom, Day-care centre, Office, Doctor's practice, Shops

Article number 0041.0231

Technical data

Model	D=Outside air and outgoing air connections upwards to the ceiling / G = Counterflow heat exchanger / SU = partially integrated, supply air and exhaust air grilles at the bottom
Air flow volume	250 m ³ /h / 870 m ³ /h
SFP value	0,2 W/(m ³ /h)
Type of voltage	Alternating current
Rated voltage	230 V
Nominal output	122 W
Stand-by power consumption	< 1 W
I _{max}	15 A
Degree of protection	IP 40
Installation site	Inside
Material	Sheet steel, galvanised
Housing material	Sheet steel, galvanised
Heat exchanger material	Synthetic material
Inner coating material	PUR foam with closed-cell surface
Colour	Pure white, similar to RAL 9010
Weight	210 kg
Weight including packaging	260 kg
Filter class	ISO ePM1 50-65% (F7) / ISO ePM10 60% (M5)
Connection diameter	315 mm
Connection diameter of condensation drain	7 mm (inside), 10 mm (outside)
Width	1.984 mm
Height	473 mm
Depth	880 mm
Width with packaging	2.070 mm
Height with packaging	950 mm
Depth with packaging	1.020 mm
Airstream temperature at I _{Max}	-15 °C up to 60 °C

geniovent.x 900 H D-G-SU

Ambient temperature	10 °C up to 40 °C
Max. degree of heat provision in accordance with DIN EN 13141-7 (A7)	91 %
Heat exchanger construction type	Counter current
Bypass	Yes
Frost protection	integrated 1.5 kW
Enthalpy heat exchanger	No
Antifreeze circuit	Yes
Filter monitoring	with time control
CO ₂ regulation (optional)	integrated
Air quality control (optional)	VOC sensor for geniovent.x
Outside air shutters, automatic closing	integrated
KNX connection (optional)	K-SM
MODBUS interface	integrated
BACnet interface	integrated
Ethernet interface	integrated
Control unit included in scope of delivery.	RB-ZF4
Control unit (optional)	RLS T1 SYS
EnOcean wireless integration (optional)	E-SM
Sound pressure level	35 dB(A)
Packing unit	1 piece
Range	X
GTIN (EAN)	4012799412311

Characteristic curve

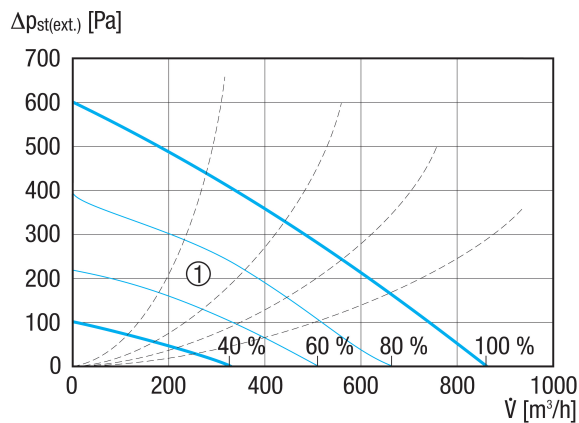

① Configuration range

geniovent.x 900 H D-G-SU

Dimensioned drawing [mm]

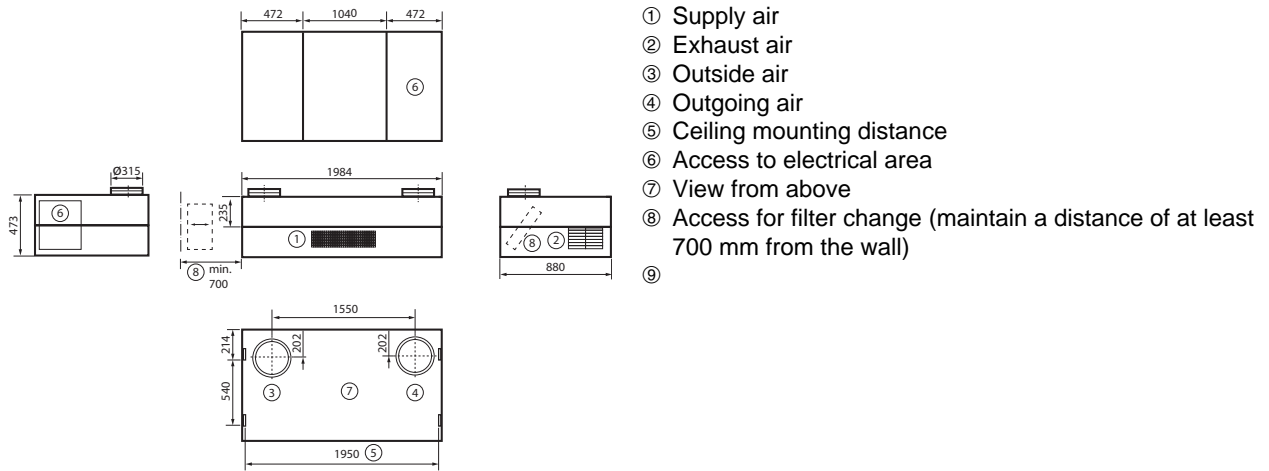

Dimensioned drawing [mm]

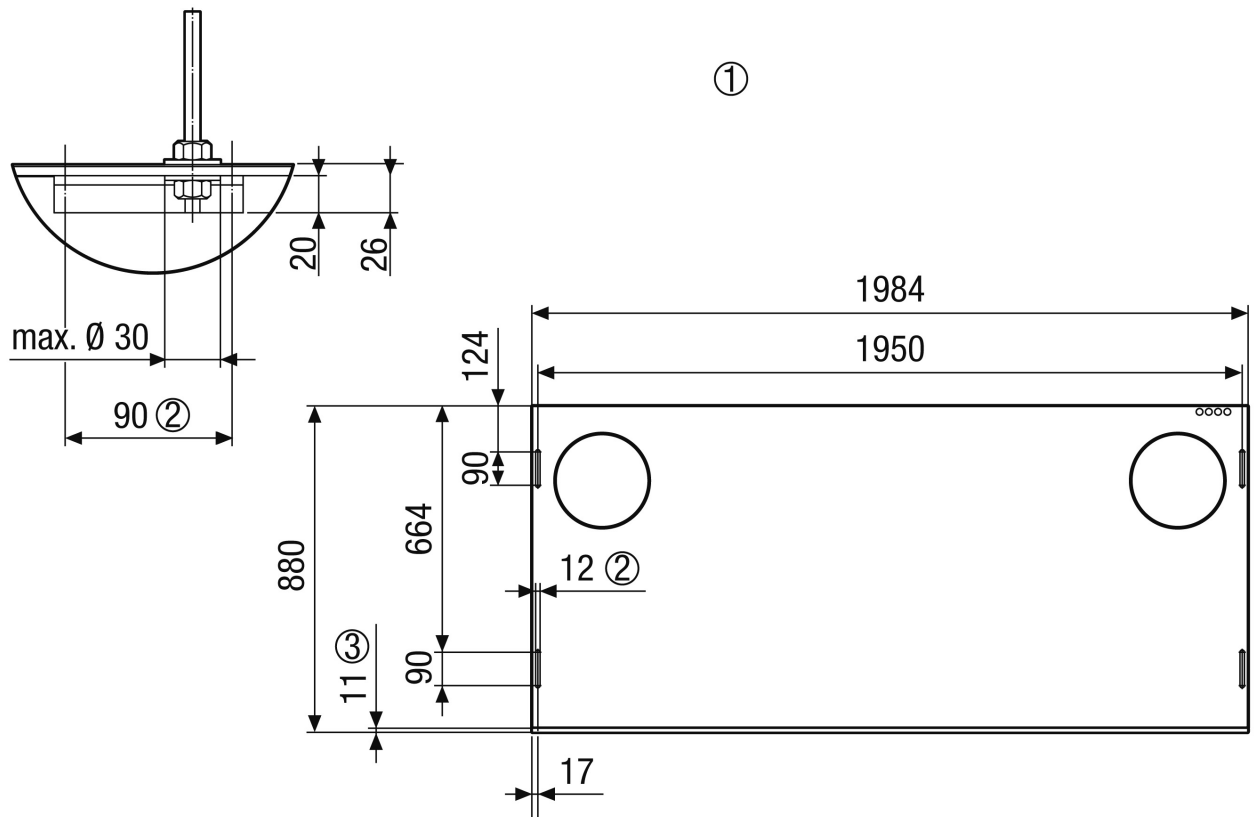

- ① Ceiling mounting geniovent.x 900 HD. View of the unit from the ceiling
- ② Slotted hole, intended for ceiling mounting, e.g. using M10 threaded rod



geniovent.x 900 H D-G-SU

③ Panels